



Road markers MarkFIX / AluFIX

Road markers MarkFIX



Road markers AluFIX



In addition to the active electric signal units from GIFAS, non-electric road markers MarkFIX and AluFIX are a suitable high-quality alternative.

The passiv GIFAS road markers are perfect for use in roundabouts and on roads and paths, especially at night or in the rain, if no power supply is available, or for cost or maintenance reasons.

Starting situation

Lanes are traditionally separated by simple marking lines. However, these can be ineffective under certain conditions and require support for improved visibility at night or in the rain. Such objects include:

- pedestrian crossing in front of a traffic island or on an approach to a roundabout
- dangerous bends or other complex traffic management systems which require enhanced marking
- allocation of specific or reserved lanes
- traffic islands
- general lane delimitations / separations

Features

The road markers MarkFIX and AluFIX are a simple and efficient instrument for effective marking at night or in the rain. Furthermore, the use of markers has an additional very interesting effect: slight repetitive vibrations can be felt when driving over these markers. These warn the driver and prevent head-on collisions and unintentional lane deviations.

- certified according to norm ASTD D4280-04 and EN 1463-1 standards
- excellent reflection values thanks to high-quality glass crystals
- MarkFIX provided with 43 and AluFIX with 43 glass crystals
- very good properties with regard to salt, abrasion, UV light and temperature fluctuations
- angle of inclination up to 30 deg.

Measurements

Road markers MarkFIX

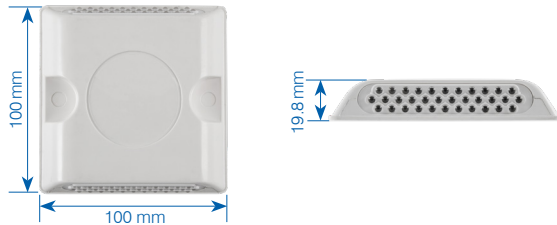

Road markers AluFIX

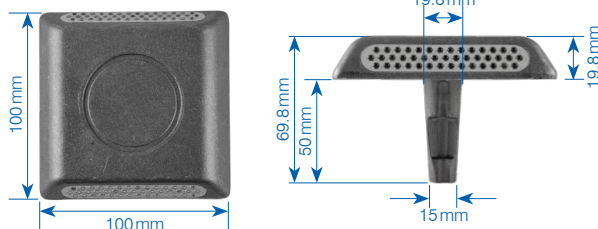

Assortment

860685	Road marker MarkFIX white plastic with 43 glass crystals, 100×100×17.9 mm
860686	Road marker AluFIX aluminium nail with 43 glass crystals, 100×100×19.8 mm

For applications on the roadway

Assortment

209785	2 Components adhesive/primer 450 ml
209786	Replacement mixing nozzle for 2 components adhesive/primer
215539	Manual dispenser for double cartridge 400 ml (1:1 and 2:1)

For applications on the shoulder

Assortment

020157	Hybrid adhesive and sealant, pebble grey, 290 ml, Permafex 153
--------	----------------------------------------------------------------

The prices are net, exclusively legal VAT currency-conditioned prize adaptations reserve.

